

# Pentagon Mortice Locks



We take the worry out of  
protecting what's valuable to you.  
Lockwood: *no worries*®

**LOCKWOOD**

**ASSA ABLOY**

**25YEAR**

**MECHANICAL  
WARRANTY**

[www.lockweb.com.au](http://www.lockweb.com.au)

# Contents



## **Pentagon™ 3P80 Series**

Mortice Locks Overview

**page 04**



## **Pentagon™ 3P82**

Short Backset Universal Locks

**page 12**



## **Pentagon™ 3P87**

Dual Entry Deadlatch

**page 19**



## **Pentagon™ 3P88**

Short Backset Holdback Locks

**page 22**

# Pentagon™ 3P80 Series Mortice Locks Overview

## Application

A comprehensive range of automatic deadlatches for narrow stile hinged doors, combining convenience and security.

## Benefits

- Ability to change lock function and handing without removing the lock from the door
- Easy in-door commissioning
- One Universal cylinder cam performs all locking functions
- Australian made
- Requires 35 degrees of lever rotation to fully retract latch and deadlatch

## Features and Specifications

Australian designed and manufactured, the 3P80 Series Short Backset Cylinder Mortice Locks are made from quality materials to meet high durability and strength requirements.

## Face Plates

- Stainless Steel 2.5mm face plates
- Brass face plates provided for plated finishes

## Case

- Galvanised Steel for increased strength and corrosion protection

## Backset

- 23mm standard backset

## Latchbolts

- Latchbolts are 15mm, stainless steel
- Deadlatching is achieved by a stainless steel auxiliary bolt

## Springs

- High-grade spring steel material, corrosion protected

## Cylinder Retaining Pin

- Hard-drawn spring steel wire, corrosion protected. Uses "slip pin" method

## Door Thickness

- Timber doors: 32 to 50mm
- Metal doors: 35 to 50mm
- Suits hollow-style aluminium door sections with 37mm minimum internal depth

## Timber Doors

Timber door accessory packs are available upon request. Specify 3P80-TF01SS for mounting tabs and face plate accessory pack.

## Door Clearance

To ensure correct functioning of the deadlatching mechanism and security for all locks, the clearance between the door and frame should be 3mm.

## Standards

All 3P80 Series locks conform to the relevant Australian Standards as detailed below.

### HIGH SECURITY

Conforms to level SL8 Australian Lock Standard (AS4145.2-2008) when fitted with door furniture and anti drill cylinder.

### DURABILITY

Exceeds level D8 (Durability) Australian Lock Standard (AS4145.2-2008)

### ANTI-CORROSION

All 3P80 Series locks meet C6 (168hrs) Australian Lock Standard (AS4145.2-2008)

## Cylinder

Bump Resistant five pin tumbler mechanism. Standard Lockwood oval shaped, brass cylinders and brass barrels

Unique universal cam drives all lock functions. Turn adaptors may be required depending on function.

## Extended Cylinders

Modular cylinder extensions are available for various door thicknesses.

## Keying

### Standard Keying

- Supplied individually keyed with two keys per cylinder
- 78000 key combinations

### Restricted Special Keying

Lockwood locks can be keyed to a number of controlled and/or specially keyed systems. These range from legally protected keys to protect against unauthorised duplication and can also include specially designed key systems such as master key systems. This allows for different levels of mechanical access control.

Please refer to [assaabloy.com.au](http://assaabloy.com.au) for keying systems or contact your local sales office or customer service for specific information.

## Standard Finishes

Stainless Steel	SS
Chrome Plate	CP
Polished Brass	PB

## Electric Strikes

ASSA ABLOY offers a wide range of electric strikes which are compatible with the Lockwood 3P80 Series Mortice Locks. Refer to [assaabloy.com.au](http://assaabloy.com.au) for further details.



# Pentagon™ 3P80 Series Mortice Locks Overview

## 1. Universal Multi-Function Lock

Lock is designed to reduce stock line items.

All functions can be achieved using the primary lock body and adjusting the Pentagon hub selector, cylinder function selector, and adding turn adaptors as required.

## 2. Hub Selection

Hub settings are conveniently adjustable via the Pentagon hub selector on the fore end of the mortice lock. Choose from Escape, Anti-lockout, or Combination function.

**Escape** – allows for single action downward action egress.

**Anti-lockout** – provides single action downward egress. The “kick-off” feature prevents accidental lockouts by unlocking the outside handle when the door is closed or operation of the inside handle.

**Combination** – allows both outside and inside handle to be locked.

Hub settings can be changed after installation without removing the lock from the door.

## 3. Cylinder Function Selection

One universal cylinder cam will work all lock functions. (Cylinder cam changes are no longer required).

Simply select locking or latching mode using the function selection tool supplied with the lock.

Functions can easily be changed once the lock is installed in the door, if required.

Uses standard Lockwood oval shaped (570) brass cylinders and barrels.

## 4. Latch Bolt

Reversible for both left and right hand doors, opening in or opening out without removing lock from the door. Simply remove face plate, pull latch away from the lock and rotate to suit inward or outward opening door.

**Note:** Handing is always viewed from external side of door.

## 5. Furniture

- Independent furniture hubs to suit Australia/New Zealand standard 7.6mm split spindle
- 35 degrees of lever rotation required to fully retract latch and auxiliary bolt
- Through fixing holes for long plate brass furniture

## 6. Cylinder/Adaptor Retention

“Slip Pin” Cylinder/Adaptor fixing method, which allows attachment to the lock case by inserting a non-threaded cylindrical pin through the front of the lock case.

## 7. Cylinder Assembly

Bump resistant five pin tumbler mechanism. Standard Lockwood oval shaped, brass cylinders and brass barrels. One universal cam will work all lock functions.

## 8. Case Assembly

Galvanised steel case and backplate provides high strength, durability and anti corrosion protection to suit the toughest applications.

## 9. Lock Fixing

Fabricator pack (aluminium doors) supplied as standard.

### **Note: Anti-Lockout Function**

Anti-Lockout function is now set using the Pentagon hub selector on the fore end of the primary lock. It can be changed after installation without removing the mortice lock from the door.

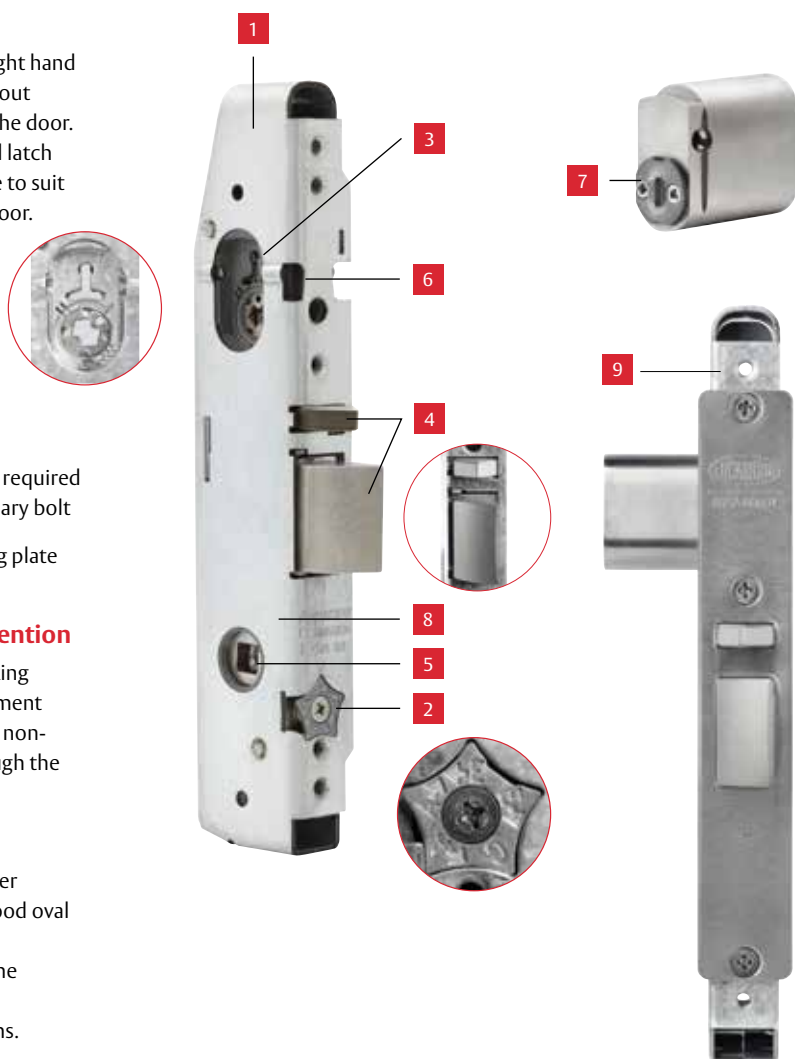

# Pentagon™ 3P80 Series Accessories

## Cylinders

Part Number	Description
570E/SC	Extended Base Cylinder with Universal Cam Adaptor (Keyed to differ)
570E/SCBK	Extended Base Cylinder with Universal Cam Adaptor (Sub-Assembly 5 Pack)

### Description

#### Extended Cylinders

Extended cylinders should be considered when a door thickness is 50mm or greater or when the lock is mounted off centre in the door.

Use Lockwood's new Modular Cylinder Extensions to produce an extended cylinder.

Virtually any length cylinder can be made by stacking as many or as few extension pieces as required together and screwing them into the back of a special extended cylinder base.

#### Cylinders

Cylinder housings are required to have 2 tapped holes in the back to accept the fixings screws. Cylinders are available for purchase using the following part numbers:

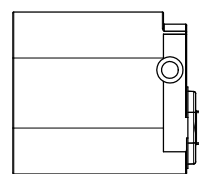

Extended Cylinder Base

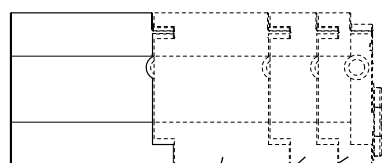

Extension Kits

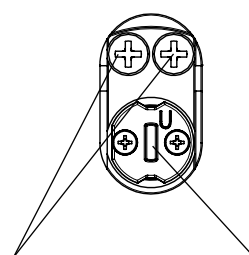

Assembly Screws

Universal Barrel Adaptor

## Screws

Part Number	Pack Size	Length "B"	Min-Max Extension (mm) If screw uncut
SRWM4-32SS	10	32	7 – 24
SRWM4-42SS	10	42	14 – 36
SRWAM4-65SS	10	65	37 – 58
SRWAM4-75SS	10	75	47 – 68

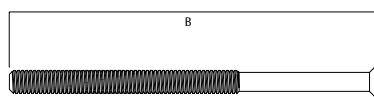

### Description

#### Screws

Screws are available in above sizes which can be cut and deburred to the desired length.

# Pentagon™ 3P80 Series Accessories

## Extended Cylinders

Overall cylinder length required	Cylinder projection (A)	Door thickness	Extended base cylinder	7mm extension kit	10mm extension kit	24mm extension kit	32mm assembly screw	42mm assembly screw	65mm assembly screw
34	36	35	49			Standard Mortice Cylinder			
41	43	49	63	1	1		2		
51	53	63	83	1	1		2		
61	63	83	103	1	1			2	
72	74	103	123	1	2	1			2
82	84	123	143	1		2			2
92	94	143	163	1		2			2

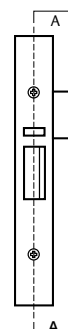

An extension guide is included to show the parts required for a particular length:

## Single Cylinder Assemblies

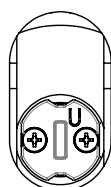

"U" CAM  
570/101

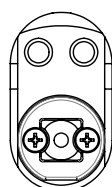

Dual Entry Cylinder  
3P87/101SC

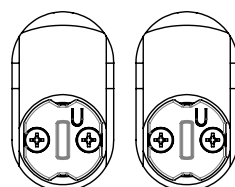

"U" CAMS  
570/201

## Adaptors

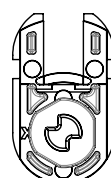

Standard Turn (T)  
3P72-STAO1

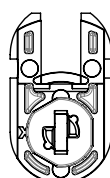

Emergency Turn (E)  
3P72-ETA01

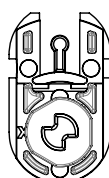

Anti-Vandal Turn (V)  
3P72-VTA01

# Pentagon™ 3P80 Series Accessories

## Timber Door Kit

**Part Number** 3P82-TF01SS

### Description

For ease of mounting to timber doors. Kit includes timber face plate and strike, and two mounting tabs which screw into the primary lock body.

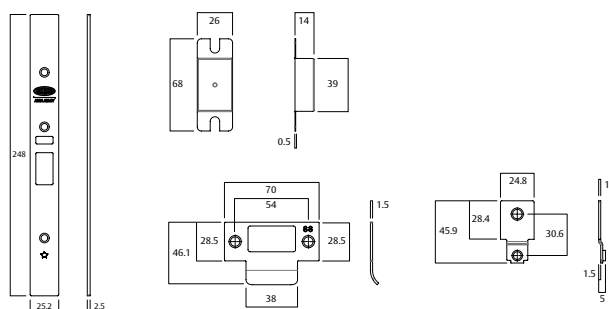

## Retrofit Strikes

Part Numbers	Finishes
3580-1902CP	Chrome Plate
3580-1902SC	Satin Chrome Brushed
3580-1902PB	Polished Brass

### Description

For replacement of existing installations where Lockwood 5900, 595 are used.

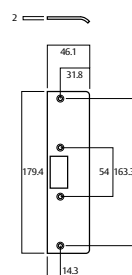

## Retrofit Face Plate

**Part Number** SP3P80-336SS

### Description

For situations where face fixing is required from the face plate.

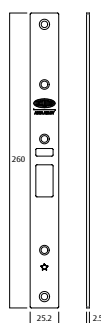

## Metal Frame Strike Kit

**Part Number** NX8/40SSS

### Description

Strike for metal frame doors. Supplied with primary lock.

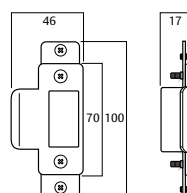

# Pentagon™ 3P80 Series Accessories

## Fabricator Strikes

**Part Number**      **Dimension "A"**

**SP3P80-053SS**      32mm

**SP3P80-153SS**      64mm

### Description

Stainless Steel D-shaped strike.

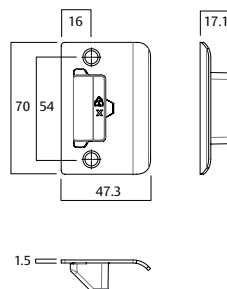

## Security Face Plate

**Part Number**      3P82-SEC01SS

### Description

For situations where added security is required, this interlocking face plate is held captive by the cylinder mechanism and can only be released when unscrewed and key is rotated.

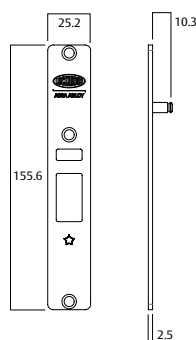

## Face Plate with Magnets

**Part Number**      SP3P80-2100SS

### Description

For use in conjunction with the Padde by Lockwood ES2100 Electric Strike.

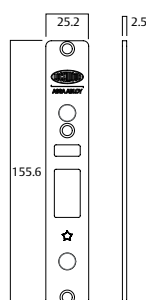



# Pentagon™ 3P80 Series Accessories

## Mortice Lock Spindles

Part Number	Pack Size	Length "A"	Door Thickness	
			Min	Max
SP3570-5018	10	33mm	32	50
SP3570-5228	10	45mm	50	75
SP3570-5238	10	58mm	75	100
SP3570-5258	10	108mm	100	200
SP3570-5328	10	125mm	200	240

**Note:** 33mm length supplied in accessory pack with primary lock.

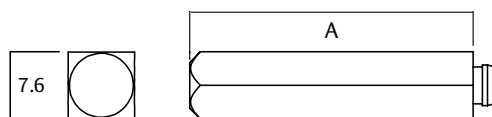

## Dual Entry Accessory Pack

**Part Number** SP3P87-119SS

### Description

To convert Pentagon 3P82 Universal Primary Lock to 3P87 Dual Entry lock.

For use with 3P87/101 Lower Cylinder.

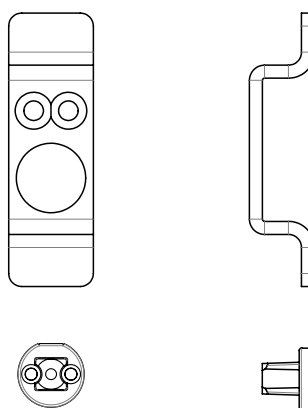

# Pentagon™ 3P80 Series Function Chart

Pentagon™ 3P80 Series Function Chart

Pentagon Series Part Number	Function Description	Primary Lock	Cylinder Quantity (570/101)	Turn Adaptor
3P82ESS-A11N	Anti-Lockout Privacy Latch	3P82	0	3P72-ETA01
3P82ESS-C11N	Privacy Latch	3P82	0	3P72-ETA01
3P82SS-A00N	Passage Latch	3P82	0	
3P82SS-C11D	Double Cylinder Glass Door Lock	3P82	2	
3P82SS-C11E	Single Cylinder Glass Entry Door Lock	3P82	1	
3P82SS-C21D	Glass Entry Door Lock	3P82	2	
3P82SS-E11E	Classroom Lock	3P82	1	
3P82SS-E11I	Single Cylinder Exit Door Lock	3P82	1	
3P82SS-E21D	Double Cylinder Escape Lock	3P82	2	
3P82SS-E23E	Storeroom Lock	3P82	1	
3P82SS-E30N	Exit Door Latch	3P82	0	
3P82TSS-A11E	Escape Office Lock - Anti-lockout	3P82	1	3P72-STA01
3P82TSS-C11E	Office Lock	3P82	1	3P72-STA01
3P82TSS-C11N	Patio Lock - turn only	3P82	0	3P72-STA01
3P82TSS-E11E	Escape Office Lock	3P82	1	3P72-STA01
3P82TSS-E11N	Exit Door Lock - turn only	3P82	0	3P72-STA01
3P82TSS-E21E	Entry Door Lock	3P82	1	3P72-STA01
3P82VSS-A11E	Entry Door Lock - Anti-vandal	3P82	1	3P72-VTA01
3P82VSS-E11E	Anti-Vandal Latch	3P82	1	3P72-VTA01
3P87SS-E11E	Dual Entry Lock - Key Lockout	3P87#	1	
3P87SS-E22E	Dual Entry Lock	3P87#	1	
3P87VSS-E11E	Dual Entry Lock - Key Lockout	3P87#	1	3P72-VTA01
3P88SS-E11E	Classroom Lock - Holdback	3P88	1	
3P88TSS-E11N	Patio Lock - turn only - Holdback	3P88	0	3P72-STA01
3P88TSS-E21E	Escape Office Lock - Holdback	3P88	1	3P72-STA01
3P88VSS-E11E	Anti-Vandal Lock - Holdback	3P88	1	3P72-VTA01

# Dual Entry lock can be made from Pentagon Universal Primary lock (eg. 3P82SS) and 3P87 Dual Entry Accessory Pack (SP3P87-119SS). Lower Cylinder 3P87/101 is also required.

# Pentagon™ 3P80 Series Functioning Matrix

## Functioning Matrix

Sample part number 3P82TSS-E21EL is made up of eleven elements.  
The description of this part number is a an entry door lock with cylinder and turn, left handing, stainless steel finish. The first six elements make up the product code, an orderable item. The remaining five elements provide the settings for the lock to function as required. These can be set at the time of installation.

Product Code						Function Settings				
Backset	System	Platform	Function	Turn Adaptor	Finish	Hub Setting	Outside Lock Function	Inside Lock Function	Cylinder Required	Handing
3	P	8	2	T	SS	E	2	1	E	L
Backset	Platform		Turn Adaptor			Hub Setting	Inside Lock Function			
23mm	3		Narrow Stile			8	Standard Turn Adaptor	T		
System		Function		Emergency Turn Adaptor		E	Combination (both handles lockable)			
Pentagon Series		P		Anti-Vandal Turn Adaptor		V	Escape (one handle always free)			
							Passage Mode			
							Lock/Unlock Mode (unlock position)			
							Key or Turn retracts latch			
							Lock/Unlock Mode (locked position)			
							Passage Mode			
							Lock/Unlock Mode (unlock position)			
							Key or Turn retracts latch			
							Lock/Unlock Mode (locked position)			
							Passage Mode			
							Lock/Unlock Mode (unlock position)			
							Key or Turn retracts latch			
							Lock/Unlock Mode (locked position)			
							Passage Mode			
							Lock/Unlock Mode (unlock position)			
							Key or Turn retracts latch			
							Lock/Unlock Mode (locked position)			
							Passage Mode			
							Lock/Unlock Mode (unlock position)			
							Key or Turn retracts latch			
							Lock/Unlock Mode (locked position)			
							Passage Mode			
							Lock/Unlock Mode (unlock position)			
							Key or Turn retracts latch			
							Lock/Unlock Mode (locked position)			
							Passage Mode			
							Lock/Unlock Mode (unlock position)			
							Key or Turn retracts latch			
							Lock/Unlock Mode (locked position)			
							Passage Mode			
							Lock/Unlock Mode (unlock position)			
							Key or Turn retracts latch			
							Lock/Unlock Mode (locked position)			
							Passage Mode			
							Lock/Unlock Mode (unlock position)			
							Key or Turn retracts latch			
							Lock/Unlock Mode (locked position)			
							Passage Mode			
							Lock/Unlock Mode (unlock position)			
							Key or Turn retracts latch			
							Lock/Unlock Mode (locked position)			
							Passage Mode			
							Lock/Unlock Mode (unlock position)			
							Key or Turn retracts latch			
							Lock/Unlock Mode (locked position)			
							Passage Mode			
							Lock/Unlock Mode (unlock position)			
							Key or Turn retracts latch			
							Lock/Unlock Mode (locked position)			
							Passage Mode			
							Lock/Unlock Mode (unlock position)			
							Key or Turn retracts latch			
							Lock/Unlock Mode (locked position)			
							Passage Mode			
							Lock/Unlock Mode (unlock position)			
							Key or Turn retracts latch			
							Lock/Unlock Mode (locked position)			
							Passage Mode			
							Lock/Unlock Mode (unlock position)			
							Key or Turn retracts latch			
							Lock/Unlock Mode (locked position)			
							Passage Mode			
							Lock/Unlock Mode (unlock position)			
							Key or Turn retracts latch			
							Lock/Unlock Mode (locked position)			
							Passage Mode			
							Lock/Unlock Mode (unlock position)			
							Key or Turn retracts latch			
							Lock/Unlock Mode (locked position)			
							Passage Mode			
							Lock/Unlock Mode (unlock position)			
							Key or Turn retracts latch			
							Lock/Unlock Mode (locked position)			
							Passage Mode			
							Lock/Unlock Mode (unlock position)			
							Key or Turn retracts latch			
							Lock/Unlock Mode (locked position)			
							Passage Mode			
							Lock/Unlock Mode (unlock position)			
							Key or Turn retracts latch			
							Lock/Unlock Mode (locked position)			
							Passage Mode			
							Lock/Unlock Mode (unlock position)			
							Key or Turn retracts latch			
							Lock/Unlock Mode (locked position)			
							Passage Mode			
							Lock/Unlock Mode (unlock position)			
							Key or Turn retracts latch			
							Lock/Unlock Mode (locked position)			
							Passage Mode			
							Lock/Unlock Mode (unlock position)			
							Key or Turn retracts latch			
							Lock/Unlock Mode (locked position)			
							Passage Mode			
							Lock/Unlock Mode (unlock position)			
							Key or Turn retracts latch			
							Lock/Unlock Mode (locked position)			
							Passage Mode			
							Lock/Unlock Mode (unlock position)			
							Key or Turn retracts latch			
							Lock/Unlock Mode (locked position)			
							Passage Mode			
							Lock/Unlock Mode (unlock position)			
							Key or Turn retracts latch			
							Lock/Unlock Mode (locked position)			
							Passage Mode			
							Lock/Unlock Mode (unlock position)			
							Key or Turn retracts latch			
							Lock/Unlock Mode (locked position)			
							Passage Mode			
							Lock/Unlock Mode (unlock position)			
							Key or Turn retracts latch			
							Lock/Unlock Mode (locked position)			
							Passage Mode			
							Lock/Unlock Mode (unlock position)			
							Key or Turn retracts latch			
							Lock/Unlock Mode (locked position)			
							Passage Mode			
							Lock/Unlock Mode (unlock position)			
							Key or Turn retracts latch			
							Lock/Unlock Mode (locked position)			
							Passage Mode			
							Lock/Unlock Mode (unlock position)			
							Key or Turn retracts latch			
							Lock/Unlock Mode (locked position)			
							Passage Mode			
							Lock/Unlock Mode (unlock position)			
							Key or Turn retracts latch			
							Lock/Unlock Mode (locked position)			
							Passage Mode			
							Lock/Unlock Mode (unlock position)			
							Key or Turn retracts latch			
							Lock/Unlock Mode (locked position)			
							Passage Mode			
							Lock/Unlock Mode (unlock position)			
							Key or Turn retracts latch			
							Lock/Unlock Mode (locked position)			
							Passage Mode			
							Lock/Unlock Mode (unlock position)			
							Key or Turn retracts latch			
							Lock/Unlock Mode (locked position)			
							Passage Mode			
							Lock/Unlock Mode (unlock position)			
							Key or Turn retracts latch			
							Lock/Unlock Mode (locked position)			
							Passage Mode			
							Lock/Unlock Mode (unlock position)			
							Key or Turn retracts latch			
							Lock/Unlock Mode (locked position)			
							Passage Mode			
							Lock/Unlock Mode (unlock position)			
							Key or Turn retracts latch			
							Lock/Unlock Mode (locked position)			
							Passage Mode			
							Lock/Unlock Mode (unlock position)			
							Key or Turn retracts latch			
							Lock/Unlock Mode (locked position)			
							Passage Mode			
							Lock/Unlock Mode (unlock position)			
							Key or Turn retracts latch			
							Lock/Unlock Mode (locked position)			
							Passage Mode			
							Lock/Unlock Mode (unlock position)			
							Key or Turn retracts latch			
							Lock/Unlock Mode (locked position)			
							Passage Mode			
							Lock/Unlock Mode (unlock position)			
							Key or Turn retracts latch			
							Lock/Unlock Mode (locked position)			
							Passage Mode			
							Lock/Unlock Mode (unlock position)			
							Key or Turn retracts latch			
							Lock/Unlock Mode (locked position)			
							Passage Mode			
							Lock/Unlock Mode (unlock position)			
							Key or Turn retracts latch			
							Lock/Unlock Mode (locked position)			
							Passage Mode			
							Lock/Unlock Mode (unlock position)			
							Key or Turn retracts latch			
							Lock/Unlock Mode (locked position)			
							Passage Mode			
							Lock/Unlock Mode (unlock position)			
							Key or Turn retracts latch			
							Lock/Unlock Mode (locked position)			
							Passage Mode			
							Lock/Unlock Mode (unlock position)			
							Key or Turn retracts latch			
							Lock/Unlock Mode (locked position)			
							Passage Mode			
							Lock/Unlock Mode (unlock position)			
							Key or Turn retracts latch			
							Lock/Unlock Mode (locked position)			
							Passage Mode			
							Lock/Unlock Mode (unlock position)			
							Key or Turn retracts latch			
							Lock/Unlock Mode (locked position)			
							Passage Mode			
							Lock/Unlock Mode (unlock position)			
							Key or Turn retracts latch			
							Lock/Unlock Mode (locked position)			
							Passage Mode			
							Lock/Unlock Mode (unlock position)			
							Key or Turn retracts latch			
							Lock/Unlock Mode (locked position)			
							Passage Mode			
							Lock/Unlock Mode (unlock position)			
							Key or Turn retracts latch			
							Lock/Unlock Mode (locked position)			
							Passage Mode			
							Lock/Unlock Mode (unlock position)			
							Key or Turn retracts latch			
							Lock/Unlock Mode (locked position)			
							Passage Mode			
							Lock/Unlock Mode (unlock position)			
							Key or Turn retracts latch			
							Lock/Unlock Mode (locked position)			
							Passage Mode			
							Lock/Unlock Mode (unlock position)			
							Key or Turn retracts latch			
							Lock/Unlock Mode (locked position)			
							Passage Mode			
							Lock/Unlock Mode (unlock position)			
							Key or Turn retracts latch			
							Lock/Unlock Mode (locked position)			
							Passage Mode			
							Lock/Unlock Mode (unlock position)			
							Key or Turn retracts latch			
							Lock/Unlock Mode (locked position)			
							Passage Mode			
							Lock/Unlock Mode (unlock position)			
							Key or Turn retracts latch			
							Lock/Unlock Mode (locked position)			
							Passage Mode			
							Lock/Unlock Mode (unlock position)			
							Key or Turn retracts latch			
							Lock/Unlock Mode (locked position)			
							Passage Mode			
							Lock/Unlock Mode (unlock position)			
							Key or Turn retracts latch			
							Lock/Unlock Mode (locked position)			
							Passage Mode			
							Lock/Unlock Mode (unlock position)			
							Key or Turn retracts latch			
							Lock/Unlock Mode (locked position)			
							Passage Mode			
							Lock/Unlock Mode (unlock position)			
							Key or Turn retracts latch			
							Lock/Unlock Mode (locked position)			
							Passage Mode			
							Lock/Unlock Mode (unlock position)			
							Key or Turn retracts latch			
							Lock/Unlock Mode (locked position)			
							Passage Mode			
							Lock/Unlock Mode (unlock position)			
							Key or Turn retracts latch			
							Lock/Unlock Mode (locked position)			
							Passage Mode			
							Lock/Unlock Mode (unlock position)			
							Key or Turn retracts latch			
							Lock/Unlock Mode (locked position)			
							Passage Mode			
							Lock/Unlock Mode (unlock position)			
							Key or Turn retracts latch			
							Lock/Unlock Mode (locked position)			
							Passage Mode			
							Lock/Unlock Mode (unlock position)			
							Key or Turn retracts latch			
							Lock/Unlock Mode (locked position)			
							Passage Mode			
							Lock/Unlock Mode (unlock position)			
							Key or Turn retracts latch			
							Lock/Unlock Mode (locked position)			
							Passage Mode			
							Lock/Unlock Mode (unlock position)			
							Key or Turn retracts latch			
							Lock/Unlock Mode (locked position)			
							Passage Mode			
							Lock/Unlock Mode (unlock position)			
							Key or Turn retracts latch			
							Lock/Unlock Mode (locked position)			
						</				

# Pentagon™ 3P82 Short Backset Universal Locks



## Description

The 3P82 Short Backset Universal Lock is a high-quality, durable lock designed for use on both new and retrofit applications. It is compatible with the Lockwood 4800 and 5800 Series Furniture. Refer to lockweb.com.au for further details. 35 degrees of lever rotation required to fully retract latch and auxiliary bolt.

**Features and Specifications**  
The 3P82 Short Backset Universal Lock is a high-quality, durable lock designed for use on both new and retrofit applications. It is compatible with the Lockwood 4800 and 5800 Series Furniture. Refer to lockweb.com.au for further details. 35 degrees of lever rotation required to fully retract latch and auxiliary bolt.

- Simple twist and tighten fixing method and lever set pre-assembly allows for super easy and super fast installation
- Available in a choice of six lever designs and three finishes
- The rose fits 50mm or 54mm diameter holes making it suitable for retrofit and common door preparations
- Designed in Australia for the specific needs of the Australian market

## Product Details

### Furniture

Compatible with Lockwood 4800 and 5800 Series Furniture. Refer to lockweb.com.au for further details. 35 degrees of lever rotation required to fully retract latch and auxiliary bolt.

### Standard Finishes

Stainless Steel (SS)  
Chrome Plate (CP)  
Polished Brass (PB)

### Timber Doors

Timber door accessory packs are available upon request. Add 3P80-TF01SS for mounting tabs and timber face plate accessory pack. in and open out applications. All latches are supplied with industry standard "D" strikes.

### Door Thickness

32mm to 45mm hinged doors

### Finishes

Satin Chrome Brushed (SC)  
Satin Chrome Pearl (SP)  
Chrome Plate (CP)

## Standards and Compliance



Fire Rated.

**S3**

High security for maximum protection (AS4145.2:1993).

**D3**

High durability for maximum frequency usage.



Anti-Corrosion.

# Pentagon™ 3P82 Short Backset Universal Locks

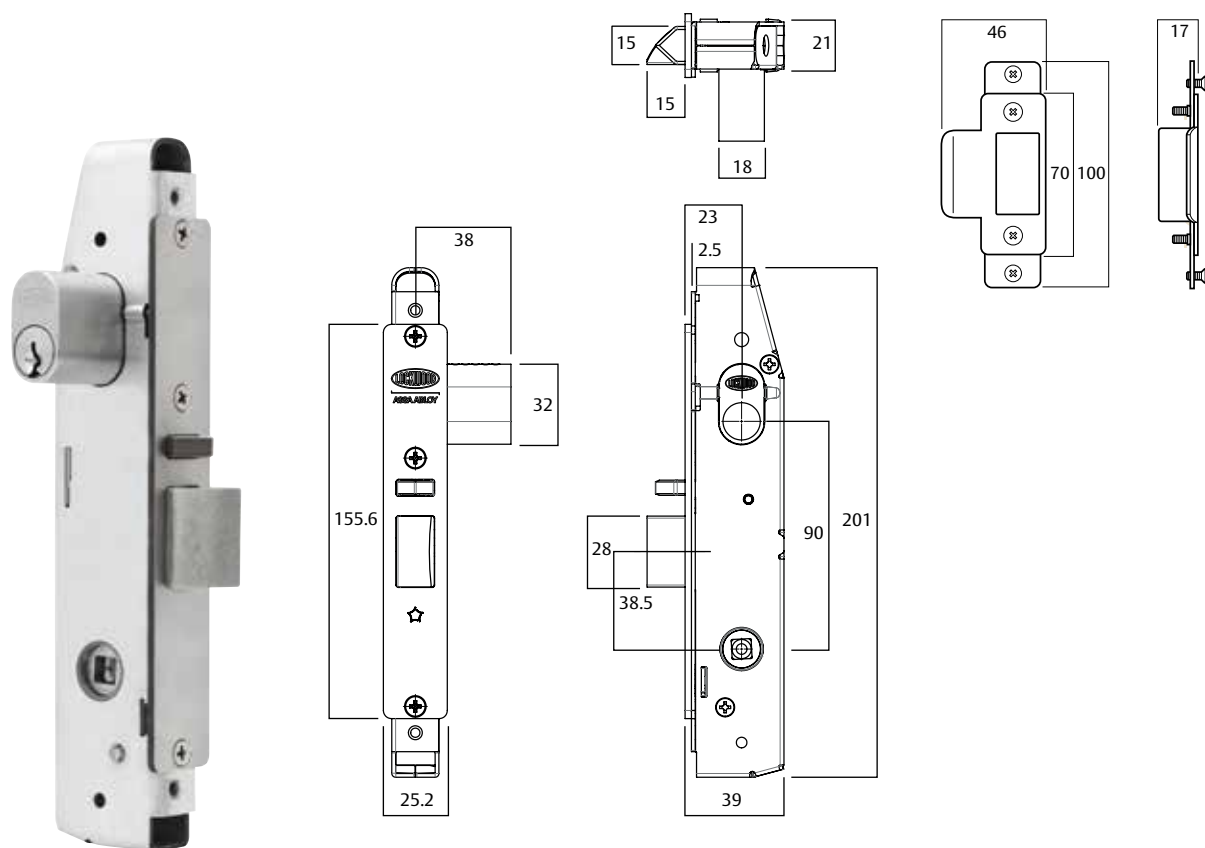

## Pentagon™ 3P82 Short Backset Universal Locks

Part Number	Description
3P82	Universal Short Backset Primary Lock
3P82T	Universal Short Backset Primary Lock with Standard Turn Adaptor
3P82E	Universal Short Backset Primary Lock with Emergency Turn Adaptor
3P82V	Universal Short Backset Primary Lock with Anti-Vandal Turn Adaptor

**Note:** Cylinders must be purchased separately.

# Pentagon™ 3P82 Short Backset Universal Locks

## Escape Locks

Allow for single downward action egress in compliance with Building Codes.

### Storeroom Lock

**Part Number** 3P82SS-E23E#

#### Description

Cylinder and Outside.

**Outside:** Opened by key. Lever is always rigid.

**Inside:** Opened by lever at all times.

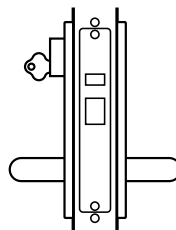

Storeroom Lock

### Classroom and Office Lock

**Part Number** 3P82SS-E11E#

#### Description

Cylinder and Outside.

**Outside:** Opened by lever except when lever is made inoperative by key from outside. Key locks or unlocks outside lever.

**Inside:** Opened by lever at all times.

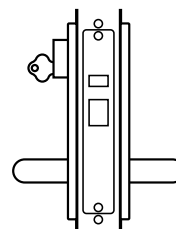

Classroom and Office Lock

### Anti-Vandal Classroom and Office Lock

**Part Number** 3P82VSS-E23E#

#### Description

Cylinder and Outside.

**Outside:** Opened by lever except when lever is locked by key from outside. Key locks or unlocks outside lever. Key can also retract latch.

**Inside:** Opened by lever at all times.

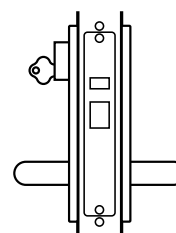

Anti-Vandal Classroom and Office Lock

**Note:** Anti-Vandal adaptor allows latchbolt to be retracted by key if lever has been rendered inoperative.

### Entry Door Lock

**Part Number** 3P82TSS-E21E#

#### Description

Cylinder and Outside.

**Outside:** Opened by key at all times. Opened by lever except when lever is locked by turnknob from inside.

**Inside:** Opened by lever at all times. Turnknob locks or unlocks outside lever.

**Note:** # indicates left (L) or right (R) handing.

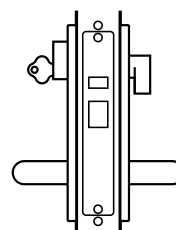

Entry Door Lock

# Pentagon™ 3P82 Short Backset Universal Locks

## Escape Locks

Allow for single downward action egress in compliance with Building Codes.

### Double Cylinder Escape Lock

**Part Number** 3P82SS-E21D#

#### Description

Double Cylinder.

**Outside:** Opened by key at all times. Opened by lever except when lever is locked by key from inside.

**Inside:** Opened by lever at all times. Key locks or unlocks outside lever.

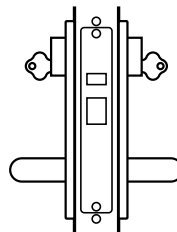

Double Cylinder Escape Lock

### Single Cylinder Exit Door Lock

**Part Number** 3P82SS-E11#

#### Description

Cylinder and Inside.

**Outside:** Opened by lever except when lever is locked by key from inside.

**Inside:** Opened by lever at all times. Key locks or unlocks outside lever.

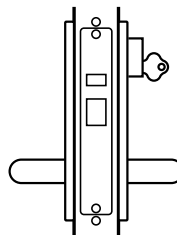

Single Cylinder Exit Door Lock

### Exit Door Lock

**Part Number** 3P82TSS-E11N#

#### Description

Turnknob Inside.

**Outside:** Opened by lever except when lever is locked by turnknob from inside.

**Inside:** Opened by lever at all times. Turnknob locks or unlocks outside lever.

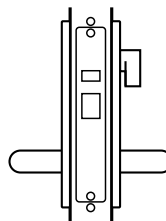

Exit Door Lock

### Exit Door Lock

**Part Number** 3P82SS-E30N#

#### Description

Exit Function only.

**Outside:** Lever is always rigid.

**Inside:** Opened by lever at all times.

**Note:** # indicates left (L) or right (R) handing.

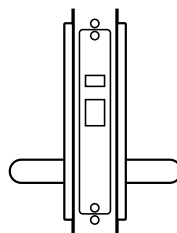

Exit Door Lock

# Pentagon™ 3P82 Short Backset Universal Locks

## Anti-Lockout Escape Locks

Allow for single downward action egress and the “kick-off” function prevents accidental lockouts by unlocking the outside lever when the door is closed or operation of the inside lever.

### Anti-Lockout Escape Lock

**Part Number** 3P82TSS-A11E#

#### Description

Cylinder and Turnknob.

**Outside:** Opened by key at all times. Opened by lever except when lever is locked by key from inside.

**Inside:** Opened by lever at all times. Key locks or unlocks outside lever.

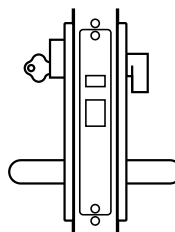

Anti-Lockout Escape Lock

### Anti-Vandal Entry Door Lock

**Part Number** 3P82VSS-A11E##

#### Description

Cylinder Outside and Turnknob.

**Outside:** Opened by key at all times. Opened by lever except when lever is locked by key from outside or turnknob from inside.

**Inside:** Opened by lever at all times. Turnknob locks or unlocks outside lever. Turnknob locks or unlocks outside lever.

**Anti-lockout:** Withdrawing the latch bolt by key, closing the door or operation of inside lever will “kick-off” the locking feature, allowing the outside lever to become operative.

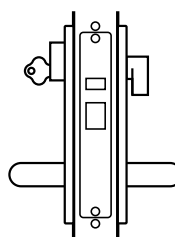

Anti-Vandal  
Entry Door Lock

**Note:** Anti-Vandal Adaptor allows latchbolt to be retracted by key if lever has been rendered inoperative.



# Pentagon™ 3P82 Short Backset Universal Locks

## Anti-Lockout Privacy Escape Lock

**Part Number** 3P82ESS-A11N#

### Description

Emergency Button and Turnknob.

**Outside:** Opened by lever except when lever is locked by turn knob from inside. Lever may be unlocked from outside by coin or screwdriver by operating the slotted emergency button.

**Inside:** Opened by lever at all times. Turn knob locks or unlocks outside lever.

**Anti-lockout:** Closing the door or operation of inside lever will "kick-off" the locking feature, allowing the outside lever to become operative.

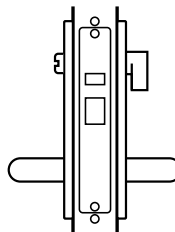

Anti-Lockout Escape Lock

## Passage Latch

**Part Number** 3P82SS-A00N#

### Description

No Locking Function.

**Outside:** Opened by lever.

**Inside:** Opened by lever.

**Note:** # indicates left (L) or right (R) handing.

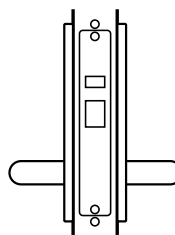

Passage Latch

# Pentagon™ 3P82 Short Backset Universal Locks

## Combination Locks

Allow both inside and outside handles to be locked.

### Office Lock

**Part Number** 3P82TSS-C11E#

#### Description

Cylinder and Turnknob.

**Outside:** Opened by lever except when lever is locked by key from outside or by turnknob from inside. Key locks or unlocks both levers.

**Inside:** Opened by lever except when lever is locked by key from outside or turnknob inside. Turnknob locks or unlocks both levers.

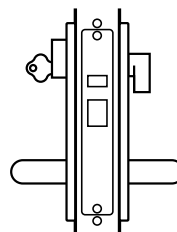

Office Lock

### Glass Entry Door Lock

**Part Number** 3P82SS-C21D#

#### Description

Double Cylinder.

**Outside:** Opened by key at all times. Opened by lever except when lever is locked by key from inside. Key retracts latchbolt.

**Inside:** Opened by lever except when lever is locked by key from inside. Key locks or unlocks both handles.

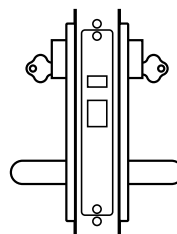

Glass Entry Door Lock

### Glass Door Lock

**Part Number** 3P82SS-C11D

#### Description

Double Cylinder.

**Outside:** Opened by lever except when lever is locked by key from either side. Key from either side locks or unlocks both levers.

**Inside:** Opened by lever except when lever is locked by key from either side. Key from either side locks or unlocks both levers.

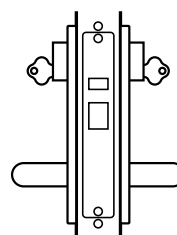

Glass Door Lock

### Privacy Lock

**Part Number** 3P82ESS-C11N#

#### Description

Emergency Button and Turnknob.

**Outside:** Opened by lever except when lever is locked by turnknob from inside. Lever may be unlocked from outside by coin or screwdriver by operating the slotted emergency turnbutton.

**Inside:** Opened by lever except when lever is made inoperative by turnknob. Turnknob locks or unlocks both levers.

**Note:** # indicates left (L) or right (R) handing.

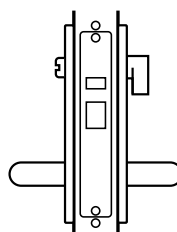

Privacy Lock

# Pentagon™ 3P87 Dual Entry Deadlatch



## Description

Designed by Lockwood, the range of doors provides a suitable solution for residential dwellings. The design is suitable for access to all types of building and is available in a choice of three finishes. The design is ideal for both new and existing applications.

## Features and Specifications

- All fixings are concealed beneath a removable rose trim providing a crisp and clean presentation desired by the discerning home owner
- Simple twist and tighten fixing method and lever set pre-assembly allows for super easy and super fast installation
- Available in a choice of six lever designs and three finishes
- The rose fits 50mm or 54mm diameter holes making it suitable for retrofit and common door preparations
- Designed in Australia for the specific needs of the Australian market

## Product Details

**Door Thickness** Metal Doors: 42 to 46mm

**Materials** Self-closing levers and 4800 are 5800 Series Self-closing levers. For further details, visit [lockweb.com.au](http://lockweb.com.au)

**Standard Finishes** Stainless Steel (SS)  
Chrome Plate (CP)  
Polished Brass (PB)  
**Latches** latch which includes an activating pin for the inside of the door and an external emergency release function. The latch is automatically released when the internal handle is operated and is easily adapted for both open in and open out applications. All latches are supplied with industry standard "D" strikes.

**Door Thickness** 32mm to 45mm hinged doors

**Finishes** Satin Chrome Brushed (SC)  
Satin Chrome Pearl (SP)  
Chrome Plate (CP)

## Standards and Compliance



Fire Rated.

**S3**

High security for maximum protection (AS4145.2:1993).

**D3**

High durability for maximum frequency usage.



Anti-Corrosion.

# Pentagon™ 3P87 Dual Entry Deadlatch

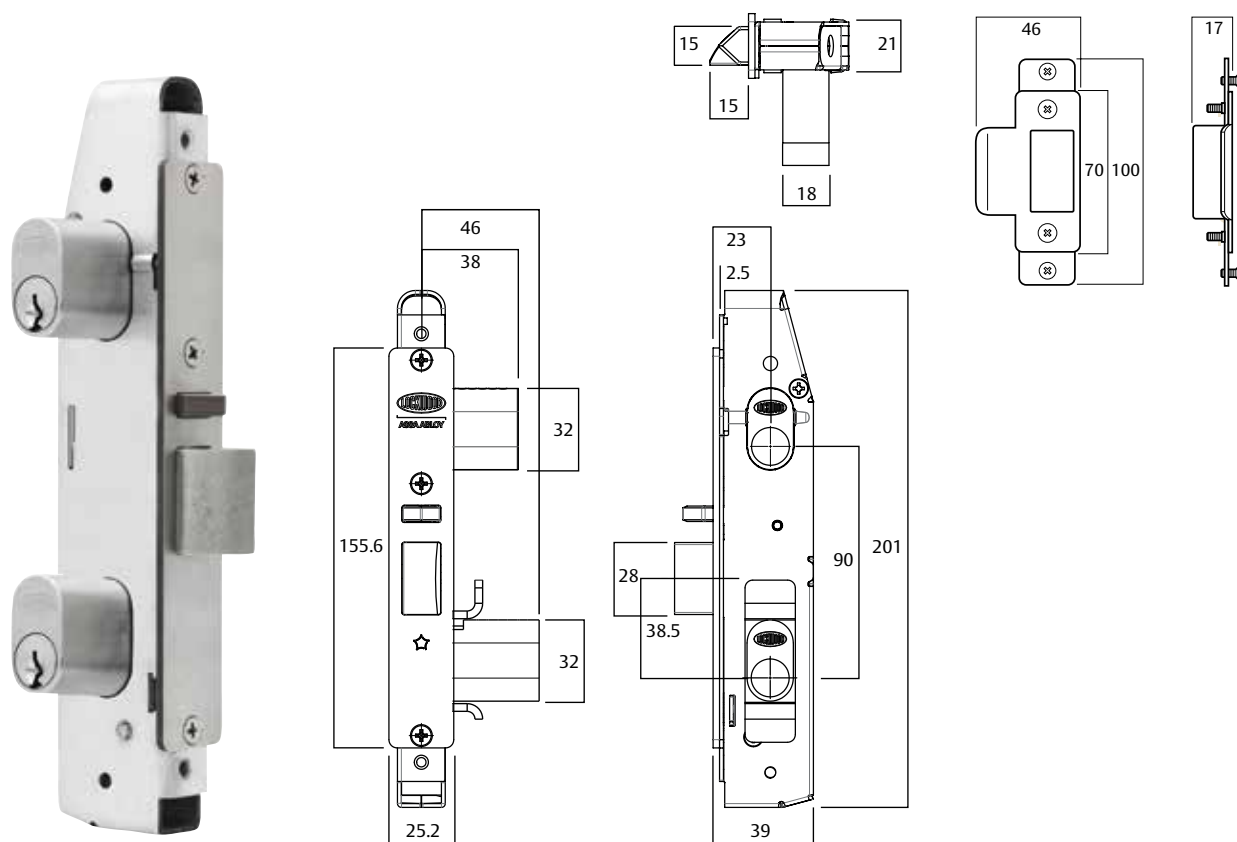

## Pentagon™ 3P87 Dual Entry Deadlatch

Part Number	Description
<b>3P87</b>	Dual Entry Primary Lock
<b>3P87V</b>	Dual Entry Primary Lock with Anti-Vandal Turn Adaptor

**Note:** Cylinders must be purchased separately. For lower cylinder order 3P87/101SC.

Pentagon 3P87 Dual Entry lock can be made from Pentagon 3P82 Universal Primary lock (eg. 3P82SS) and 3P87 Dual Entry Accessory Pack (SP3P87-119SS).

# Pentagon™ 3P87 Dual Entry Deadlatch

## Dual Entry Lock

**Part Number** 3P87SS-E22E#

### Description

Two Cylinders Outside.

**Outside:** Opened by either key, cylinders are keyed to differ.

**Inside:** Opened by lever at all times.

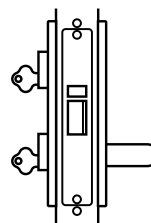

Dual Entry Lock

## Key Lockout Lock

**Part Number** 3P87SS-E11E#

### Description

Two Cylinders Outside.

**Outside:** Opened by bottom key. Top key locks and unlocks bottom key, but will not allow access without bottom key holder present.

**Inside:** Opened by lever at all times.

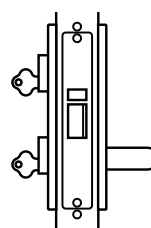

Key Lockout Lock

## Dual Entry/Key Lockout Lock

**Part Number** 3P87VSS-E11E#

### Description

Two Cylinders Outside.

**Outside:** Opened by bottom key when made operative by top key.

Top key locks or unlocks bottom key and retracts latch.

**Inside:** Opened by lever at all times.

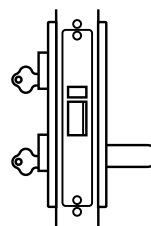

Dual Entry/Key Lockout Lock

# Pentagon™ 3P88 Short Backset Holdback Locks



## Description

The Velocity Series is developed for applications where a suitable holdback is required. Designed to suit common door preparations in the Australian market, Velocity is ideal for both new and retrofit applications.

## Features and Specifications

- All fixings are concealed beneath a removable rose trim providing a crisp and clean presentation desired by the discerning home owner
- Simple twist and tighten fixing method and lever set pre-assembly allows for super easy and super fast installation
- Available in a choice of six lever designs and three finishes
- The rose fits 50mm or 54mm diameter holes making it suitable for retrofit and common door preparations
- Designed in Australia for the specific needs of the Australian market

## Product Details

<b>Furniture</b>	Compatible with Lockwood 4800 and 5800 Series Furniture. Refer to <a href="http://lockweb.com.au">lockweb.com.au</a> for further details.
<b>Materials</b>	Depressed when latch is depressed and key rotated 90 degrees.
<b>Latch Holdback</b>	Passage sets are available both with and without a Stainless Steel (SS)
<b>Standard Finishes</b>	Chrome Plate (CP) Polished Brass (PB)
<b>Latches</b>	the door and an external emergency release function. The latch is automatically released when the internal handle is operated and is easily adapted for both open in and open out applications. All latches are supplied with industry standard "D" strikes.
<b>Door Thickness</b>	32mm to 45mm hinged doors
<b>Finishes</b>	Satin Chrome Brushed (SC) Satin Chrome Pearl (SP) Chrome Plate (CP)

## Standards and Compliance



Fire Rated.

**S3**

High security for maximum protection (AS4145.2:1993).

**D3**

High durability for maximum frequency usage.



Anti-Corrosion.

# Pentagon™ 3P88 Short Backset Holdback Locks

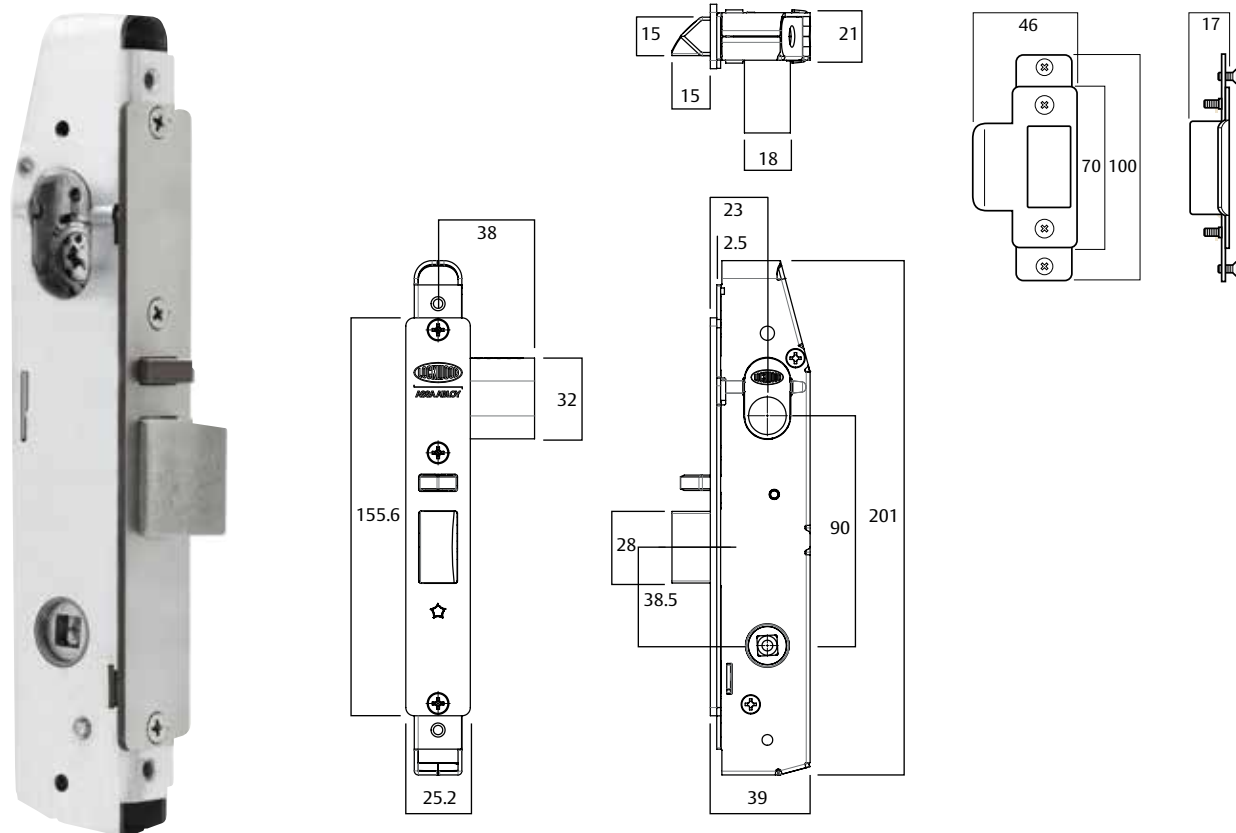

## Pentagon™ 3P88 Short Backset Holdback Locks

Part Number	Description
3P88	Short Backset Holdback Lock
3P88T	Short Backset Holdback Lock with Standard Turn Adaptor
3P88V	Short Backset Holdback Lock with Anti-Vandal Turn Adaptor

**Note:** Cylinders must be purchased separately.

# Pentagon™ 3P88 Short Backset Holdback Locks

## Escape Office Lock with Holdback

**Part Number** 3P88TSS-E21E#

### Description

Cylinder and Turnknob.

**Outside:** Opened by key at all times. Opened by lever except when lever is locked by turnknob from inside.

**Inside:** Opened by locked at all times. Turnknob locks or unlocks outside lever.

**Holdback:** Latchbolt holdback engaged when latch depressed and snib turned 90°.

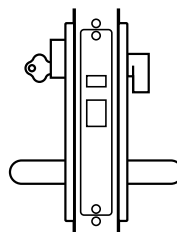

Escape Office Lock with Holdback

## Anti-Vandal Lock with Holdback

**Part Number** 3P88VSS-E23E#

### Description

Cylinder Outside.

**Outside:** Opened by key. Lever is always rigid.

**Inside:** Opened by lever at all times.

**Holdback:** Latchbolt holdback engaged when latch depressed and key rotated 90°.

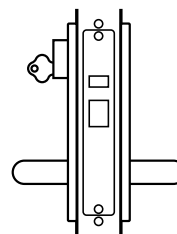

Anti-Vandal Lock with Holdback

## Classroom and Office Lock with Holdback

**Part Number** 3P88SS-E11E#

### Description

Cylinder Outside.

**Outside:** Opened by lever except when lever is locked by key from outside. Key locks or unlocks outside lever.

**Inside:** Opened by lever at all times.

**Holdback:** Latchbolt holdback engaged when latch depressed and key rotated 90°.

**Note:** # indicates left (L) or right (R) handing.

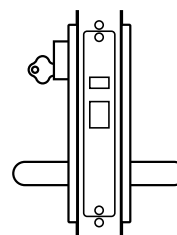

Classroom and Office Lock with Holdback



# Synergy Series Conversion Chart

## Synergy Series Conversion Chart

Synergy Series	Pentagon Series	Function Description
3582-T#SC	3P82TSS-E11N	Exit Door Lock - turn only
3582WA#SC	3P82TSS-A11E	Escape Office Lock - Anti-lockout
3582WT#SC	3P82TSS-E11E	Escape Office Lock
3582X-#SC	3P82SS-E23E	Storeroom Lock
3582XT#SC	3P82TSS-E21E	Entry Door Lock
3582XZ#SC	3P82SS-E21D	Double Cylinder Escape Lock
3582-Z#SC	3P82SS-E11I	Single Cylinder Exit Door Lock
3582Z-#SC	3P82SS-E11E	Classroom Lock
3584ET#SC	3P82ESS-E11N	Privacy Latch
3584SC	3P82SS-A00N	Passage Latch
3584-T#SC	3P82TSS-C11N	Patio Lock - turn only
3584WT#SC	3P82TSS-C11E	Office Lock
3584XZ#SC	3P82SS-C21D	Glass Entry Door Lock
3584Z-#SC	3P82SS-C11E	Single Cylinder Glass Entry Door Lock
3584ZZ#SC	3P82SS-C11D	Double Cylinder Glass Door Lock
3588M-#SC	3P88VSS-E11E	Anti-Vandal Latch - Holdback
3588-T#SC	3P88TSS-E11N	Patio Lock - turn only - Holdback
3588XT#SC	3P88TSS-E21E	Entry Door Lock - Holdback
3588Z-#SC	3P88SS-E11E	Classroom Lock - Holdback



**Lockwood** is the leading brand in the Australian locking industry. With an established reputation for high quality products, this iconic brand provides a wide range of locking solutions to residential housing, commercial building and industrial application markets. Lockwood is supported by an extensive distribution and after-sales support network. Our customers include retailers, architects, trade and industrial personnel, locksmiths and security dealers.

**ASSA ABLOY** is the global leader in door opening solutions, dedicated to satisfying end-user needs for security, safety and convenience.

**ASSA ABLOY** is represented in all major regions, in both mature and emerging markets, with leading positions in Australia, Europe and North America.



#### **The Lockwood 25 Year Mechanical Warranty**

Our belief that we manufacture the finest premium products available in today's market place is backed by the Lockwood 25 Year Mechanical Warranty, ensuring that Lockwood continues to keep Australians safe by delivering security and peace of mind.

For warranty terms and conditions, please visit [www.lockweb.com.au](http://www.lockweb.com.au) or call **1300WARRANTY**

**ASSA ABLOY Australia Pty Ltd**  
235 Huntingdale Road  
Oakleigh, Victoria, 3166  
Australia

**1300 LOCK UP (1300 562 587)**  
[lockweb.com.au](http://lockweb.com.au)

**ASSA ABLOY New Zealand Ltd**  
6 Armstrong Road  
Albany, Auckland, 0632  
New Zealand

[info.nz@assaabloy.com](mailto:info.nz@assaabloy.com)  
Telephone +64 9415 7111  
[assaabloy.co.nz](http://assaabloy.co.nz)

